

Air Operated Oil Pumps

Series 200 1:1 Ratio Up to 9.25 GPM(US) – 35 Liters /min
for maintenance and light production applications



Series 200 1:1 ratio air-operated pumps for transferring low and medium viscosity fluids such as hydraulic oil, engine oil, transmission fluid over short distances.



Part Number

26091-55

26094-55

Compatible fluids	lubricants, hydraulic fluid, transmission fluid	lubricants, hydraulic fluid, transmission fluid
Type of Seals	Viton	Viton
Suction Tube – Upper Body	Aluminum	Aluminum
Suction Tube	Carbon Steel	Carbon Steel
Air Inlet Connection	¼" NPT(f)	¼" NPT(f)
Fluid Outlet Connection	¾" NPT(f)	¾" NPT(f)
Maximum Air Pressure	120 psi	120 psi
Maximum Air Consumption @120 psi	15 cfm	15 cfm
Noise Level	81 dB	81 dB
Suitable for Drums	Modular – order suction tube to suit	55 Gal (US) – 205 Liter
Suction Tube Length	Order to suit container	37"
Suction Tube External Diameter	1.97"	1.97"
Max. Deliverable Fluid Viscosity	SAE 90	SAE 90

PRO/MARK INDUSTRIALS

Div. R.D. Lewis Sales Limited

Manufacturer's Representative

Applied Lubrication Technology Inc.

Air Operated Oil Pumps



Series 238 1:1 Ratio Up to 6 GPM (US) – 23 Liters/min for maintenance and production applications

Series 238 1:1 ratio air-operated pumps for transferring low and medium viscosity fluids such as hydraulic oil, engine oil, transmission fluid over short distances.



Part Number	33061-55	33096-55	33071-55	33073-55
Compatible fluids	lubricants, hydraulic fluid, trans. fluid	lubricants, hydraulic fluid, trans. fluid	Industrial Fluids	Industrial Fluids
Type of Seals	PTFE (Teflon)	PTFE (Teflon)	Viton	Viton
Suction Tube – Upper Body	Aluminum	Aluminum	Aluminum	Aluminum
Suction Tube	Carbon Steel	Carbon Steel	Carbon Steel	Carbon Steel
Air Inlet Connection	¼" NPT(f)	¼" NPT(f)	¼" NPT(f)	¼" NPT(f)
Fluid Outlet	½" NPT(f)	½" NPT(f)	½" NPT(f)	½" NPT(f)
Maximum Air Pressure	120 psi	120 psi	120 psi	120 psi
Max. Air Cons. @120 psi	13 cfm	13 cfm	13 cfm	13 cfm
Noise Level	81 dB	81 dB	81 dB	81 dB
Suitable for Drums	Modular – order suction tube to suit	55 Gal (US) – 205 Liter	Modular – order suction tube to suit	55 Gal (US) – 205 Liter
Suction Tube Length	Order suction tube to suit container	37"	Order suction tube to suit container	37"
Suction Tube O.D.	1.65"	1.65"	1.65"	1.65"
Max. Fluid Viscosity	SAE 80	SAE 80	SAE 80	SAE 80

PRO/MARK INDUSTRIALS
Div. R.D. Lewis Sales Limited
Manufacturer's Representative





Air Operated Oil Pumps



Series 200 3:1 Ratio Up to 5.3 GPM (US) – 20 Liters/min
for maintenance and production applications

Series 200 3:1 ratio air-operated pumps for transferring low and high viscosity fluids such as hydraulic oil, engine oil, transmission fluid over short to medium distances.

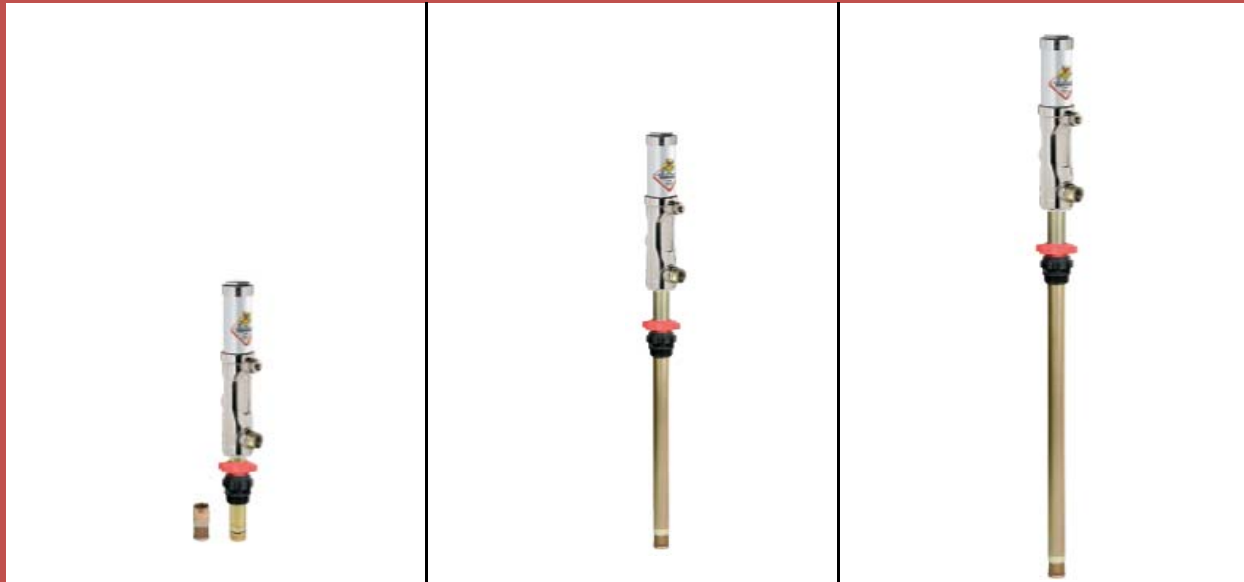

Part Number

35061-55

35076-55

35094-55

Compatible fluids	lubricants, hydraulic fluid, trans. fluid	lubricants, hydraulic fluid, trans. fluid	lubricants, hydraulic fluid, trans. fluid
Type of Seals	Viton	Viton	Viton
Suction Tube – Upper Body	Aluminum	Aluminum	Aluminum
Suction Tube	Carbon Steel	Carbon Steel	Carbon Steel
Air Inlet Connection	¼" NPT(f)	¼" NPT(f)	¼" NPT(f)
Fluid Outlet	½" NPT(f)	½" NPT(f)	½" NPT(f)
Maximum Air Pressure	120 psi	120 psi	120 psi
Max. Air Cons. @120 psi	23 cfm	23 cfm	23 cfm
Noise Level	81 dB	81 dB	81 dB
Suitable for Drums	Modular – order suction tube to suit	16 Gal (US) – 60 Liter	55 Gal (US) – 205 Liter
Suction Tube Length	Order to suit container	29"	37"
Suction Tube O.D.	1.34"	1.34"	1.34"
Max. Fluid Viscosity	SAE 130	SAE 130	SAE 130

PRO/MARK INDUSTRIALS

Div. R.D. Lewis Sales Limited

Manufacturer's Representative



Air Operated Oil Pumps



Series 238 3:1 Ratio Up to 4.4 GPM (US) – 17 Liters/min
for maintenance and production applications

Series 238 3:1 ratio air-operated pumps for transferring low and high viscosity fluids such as hydraulic oil, engine oil, transmission fluid over short to medium distances.

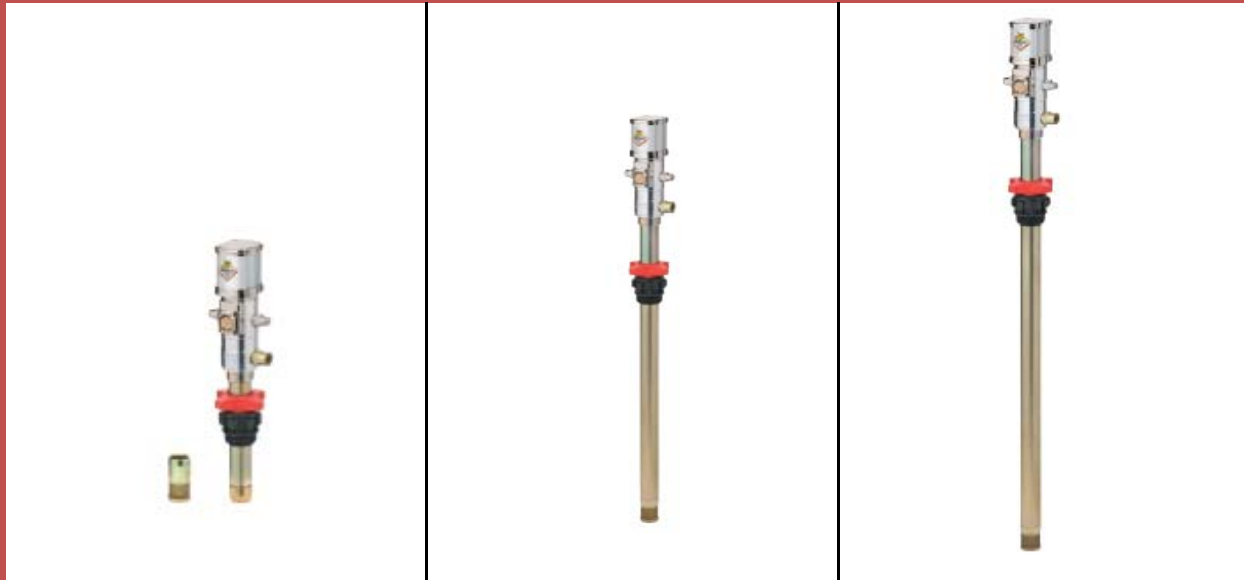

Part Number	35061-55	35076-55	35094-55
Compatible fluids	lubricants, hydraulic fluid, trans. fluid	lubricants, hydraulic fluid, trans. fluid	lubricants, hydraulic fluid, trans. fluid
Type of Seals	NBR	NBR	NBR
Suction Tube – Upper Body	Aluminum	Aluminum	Aluminum
Suction Tube	Carbon Steel	Carbon Steel	Carbon Steel
Air Inlet Connection	¼" NPT(f)	¼" NPT(f)	¼" NPT(f)
Fluid Outlet	½" NPT(f)	½" NPT(f)	½" NPT(f)
Maximum Air Pressure	120 psi	120 psi	120 psi
Max. Air Cons. @120 psi	26 cfm	26 cfm	26 cfm
Noise Level	81 dB	81 dB	81 dB
Suitable for Drums	Modular – order suction tube to suit	16 Gal (US) – 60 Liter	55 Gal (US) – 205 Liter
Suction Tube Length	Order to suit container	29"	37"
Suction Tube O.D.	1.34"	1.34"	1.34"
Max. Fluid Viscosity	SAE 130	SAE 130	SAE 130

PRO/MARK INDUSTRIALS
Div. R.D. Lewis Sales Limited
Manufacturer's Representative



Mobile Air Operated Oil Pumps

With Series 200 3:1 Pump



Dolly-mounted oil dispenser kit. The ideal combination for dispensing oil in any workplace. The very easy to handle dolly is equipped with a drum (45 gal/205 L) clamping device, adjustable side support for stowing accessories, wheel with brake. The mobile unit comes with a handy hose reel with 33' of hose, and control handle with electronic meter.



Package Part No.	P/N 35198-55	P/N 35199-55	P/N 35219-55	P/N 35220-55
3:1 Ratio Pump	35094-55	35567-55	35094-55	35567-55
Heavy Duty Dolly	80210-55	80210-55	80200-55	
Hose Reel ½" x 35 ft.	8430.401-55	8430.401-55		
Bung Adaptor	38046-55	38042-55	38046-55	38042-55
Digital Meter	37739-55	37739-55	37739-55	37739-55
Dispense Hose	996.302-55 ½" x 7 ft.	996.302-55 ½" x 7 ft.	996.334-55 ½" x 213 ft.	996.334-55 ½" x 213 ft.

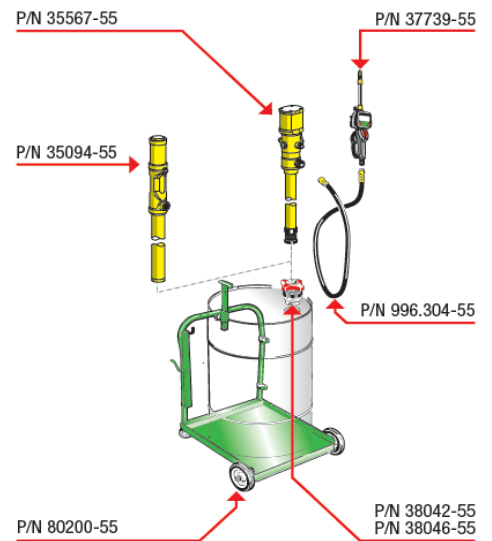
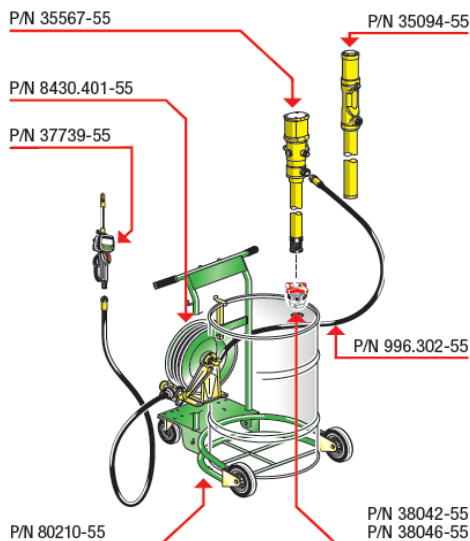

PRO/MARK INDUSTRIALS

Div. R.D. Lewis Sales Limited
Manufacturer's Representative

**Applied
Lubrication
Technology Inc.**

P.O. Box 1504, Woodstock, ON N4S 0A7 Phone: (519) 469-9979 E-Mail: sales@promarkindustrials.com

Mobile Air Operated Oil Pumps

With Series 238 3:1 Ratio Pumps



Dolly-mounted oil dispenser kit. The ideal combination for dispensing oil in any workplace. The compact dolly has 2 fixed wheels and 2 swivel castors that make it very easy to handle. It is equipped with a pump support and is suitable for holding various types of containers (16 gal/60 L).



Package Part No.

P/N 35198-55

P/N 35219-55

P/N 35220-55

Pump

35564-55

35564-55

35564-55

Dolly

80050-55

80050-55

Drum Cover

65138-55

65138-55

Bung Adaptor

38042-55

38042-55

38042-55

Digital Meter

37739-55

37739-55

37739-55

Dispense Hose

996.304-55 ½" x 13 Ft.

996.304-55 ½" x 13 Ft.

996.304-55 ½" x 13 Ft.

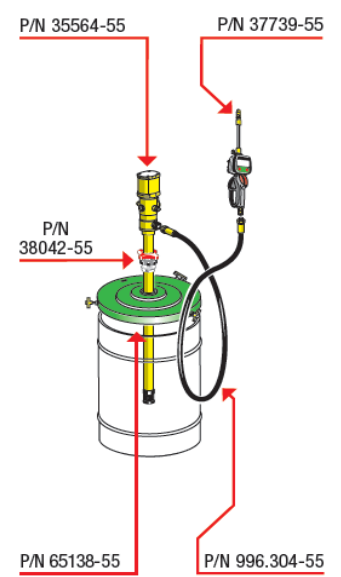
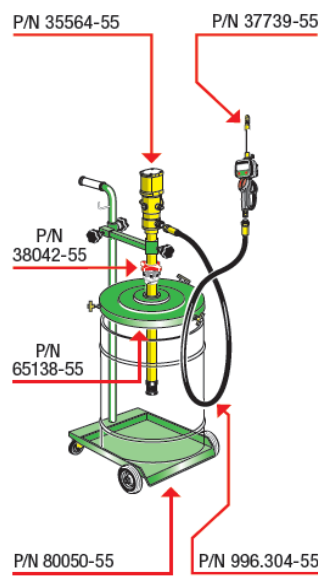
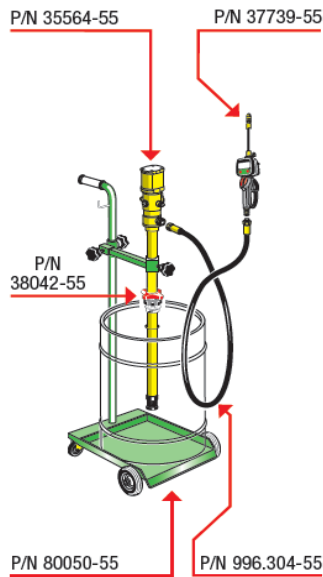

PRO/MARK INDUSTRIALS

Div. R.D. Lewis Sales Limited

Manufacturer's Representative



Mobile Air Operated Oil Pumps

With Series 200 3:1 Ratio Pumps



Dolly-mounted oil dispenser kit. The ideal combination for dispensing oil in any workplace. The compact dolly has 2 fixed wheels and 2 swivel castors that make it very easy to handle. It is equipped with a pump support and is suitable for holding various types of containers (16 gal/60 L).



Package Part No.	P/N 35260-55	P/N 35263-55	P/N 35264-55
Pump	35076-55	35076-55	35076-55
Dolly	80050-55	80050-55	
Drum Cover		65138-55	65138-55
Bung Adaptor	38046-55	38046-55	38046-55
Digital Meter	37739-55	37739-55	37739-55
Dispense Hose	996.304-55 ½" x 13 Ft.	996.304-55 ½" x 13 Ft.	996.304-55 ½" x 13 Ft.

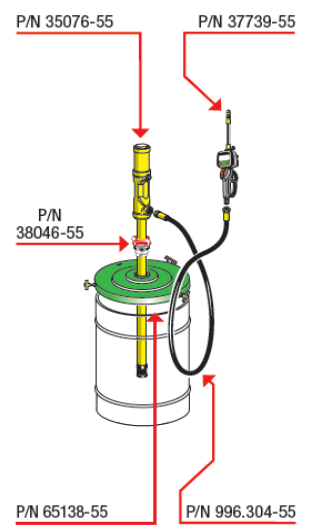
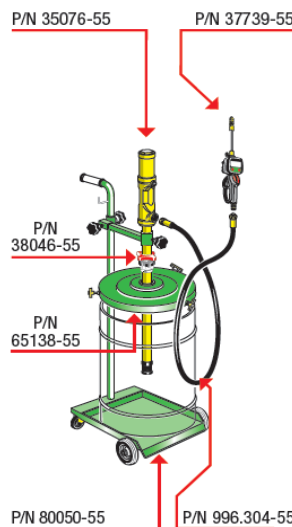
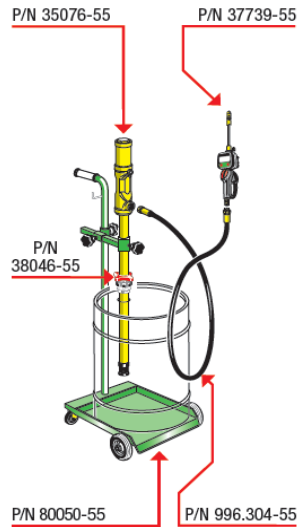

PRO/MARK INDUSTRIALS

Div. R. D. Lewis Sales Limited

Manufacturer's Representative



Modular Air Operated Oil Pump Packages

With Series 238 3:1 Ratio Pumps



System for oil dispensing from tank with pump applied on wall. A modular solution for oil delivery with connection to a centralized system or hose reel or directly to the delivery hose. Ideal for distribution from storage zones.



Note: the tank is not part of the kit

Package Part No.

P/N 35285-55

P/N 36613-55

Pump

35561-55

35561-55

Hose Reel ½" x 33 ft.

8430.401-55

Bung Adaptor

38042-55

38042-55

Digital Meter

37739-55

Extension 1.3" O.D.

10/23-55 37.8"

Flexible Suction Tube

38026-55

Rigid Suction Tube

38027-55

Pump Support Bracket

38053-55

36602-55

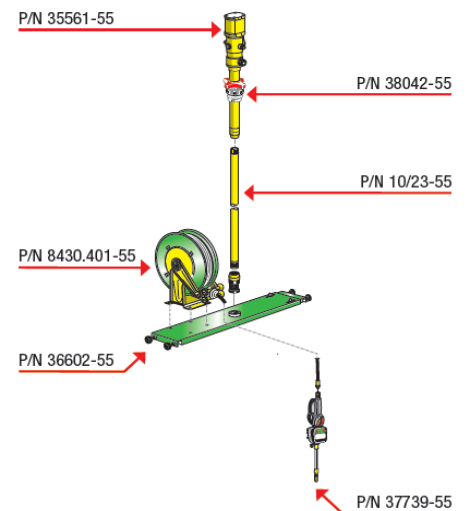
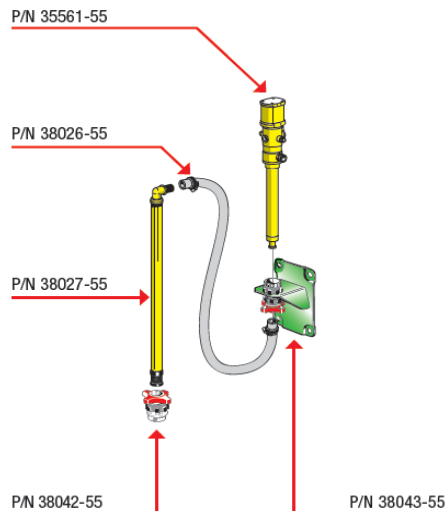

PRO/MARK INDUSTRIALS

Div. R.D. Lewis Sales Limited

Manufacturer's Representative

**Applied
Lubrication
Technology Inc.**

Air Operated Oil Pumps



Series 238 5:1 Ratio Up to 5.5 GPM (US) – 21 Liters/min
for maintenance and production applications

Series 238 5:1 ratio air-operated pumps for transferring low and high viscosity fluids such as hydraulic oil, engine oil, gear lubricants, transmission fluid, etc., over short to long distances.



36161-55



36164-55



36167-55

Part Number	36161-55	36164-55	36167-55
Compatible fluids	lubricants, hydraulic fluid, gear lubes, trans. fluid	lubricants, hydraulic fluid, gear lubes, trans. fluid	lubricants, hydraulic fluid, gear lubes, trans. fluid
Type of Seals	NBR	NBR	NBR
Suction Tube – Upper Body	Aluminum	Aluminum	Aluminum
Suction Tube	Carbon Steel	Carbon Steel	Carbon Steel
Air Inlet Connection	¼" NPT(f)	¼" NPT(f)	¼" NPT(f)
Fluid Outlet	½" NPT(f)	½" NPT(f)	½" NPT(f)
Maximum Air Pressure	120 psi	120 psi	120 psi
Max. Air Cons. @120 psi	30 cfm	30 cfm	30 cfm
Noise Level	81 dB	81 dB	81 dB
Suitable for Drums	Modular – order suction tube to suit	16 Gal (US) – 60 Liter	55 Gal (US) – 205 Liter
Suction Tube Length	Order to suit container	29"	37"
Suction Tube O.D.	1.34"	1.34"	1.34"
Max. Fluid Viscosity	SAE 230	SAE 230	SAE 230

PRO/MARK INDUSTRIALS
Div. R.D. Lewis Sales Limited
Manufacturer's Representative



Mobile Air Operated Oil Pumps

With Series 238 5:1 Pump

With Series 238 5:1 Pump



Dispenser kit. The ideal combination for dispensing oil in any workplace. The very easy to handle dolly is equipped with a drum (45 gal/205 L) clamping device, adjustable side support for stowing accessories, wheel with brake. The mobile unit comes with a handy hose reel with 33' of hose, and control handle with electronic meter.



Package Part No.

P/N 37099-55

P/N 37200-55

3:1 Ratio Pump

36167-55

36167-55

Heavy Duty Dolly

80210-55

80200-55

Hose Reel ½" x 35 ft.

8430.401-55

Bung Adaptor

38042-55

38042-55

Digital Meter

37739-55

37739-55

Dispense Hose

996.302-55
½" x 7 ft.

996.304-55
½" x 13 ft.

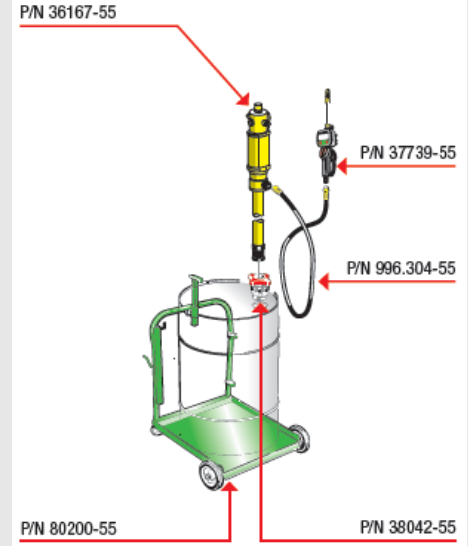
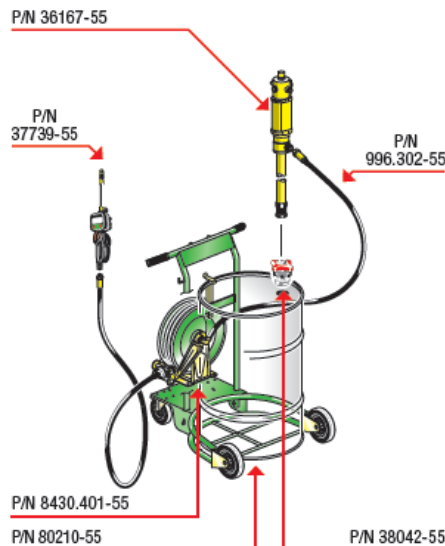

PRO/MARK INDUSTRIALS

Div. R.D. Lewis Sales Limited
Manufacturer's Representative



Mobile Air Operated Oil Pumps

With Series 238 5:1 Ratio Pumps



Dolly-mounted oil dispenser kit. The ideal combination for dispensing oil in any workplace. The compact dolly has 2 fixed wheels and 2 swivel castors that make it very easy to handle. It is equipped with a pump support and is suitable for holding various types of containers (16 gal/60 L).



Package Part No.	P/N 37500-55	P/N 37503-55	P/N 37504-55
Pump	36164-55	36164-55	36164-55
Dolly	80050-55	80050-55	80050-55
Drum Cover		65138-55	65138-55
Bung Adaptor	38042-55	38042-55	38042-55
Digital Meter	37739-55	37739-55	37739-55
Dispense Hose	996.304-55 ½" x 13 Ft.	996.304-55 ½" x 13 Ft.	996.304-55 ½" x 13 Ft.

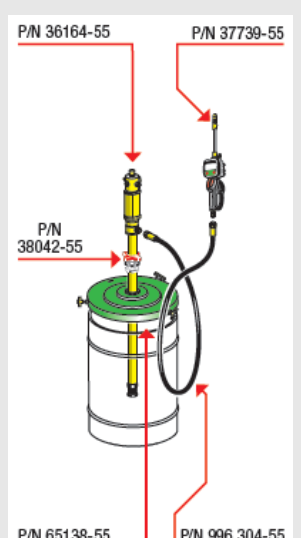
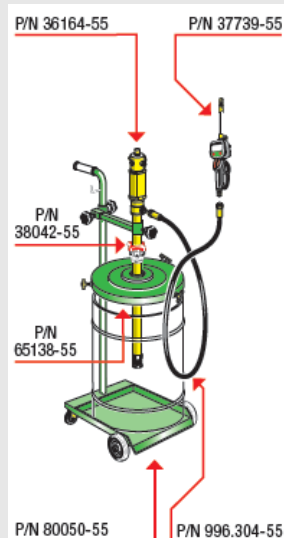
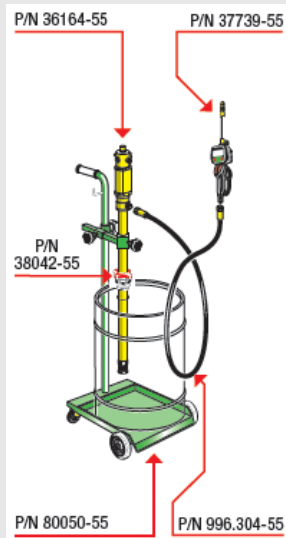

PRO/MARK INDUSTRIALS

Div. R.D. Lewis Sales Limited

Manufacturer's Representative

**Applied
Lubrication
Technology Inc.**

Modular Air Operated Oil Pump Packages

With Series 238 5:1 Ratio Pumps



System for oil dispensing from tank with pump applied on wall. A modular solution for oil delivery with connection to a centralized system or hose reel or directly to the delivery hose. Ideal for distribution from storage zones.



Note: the tank is not part of the kit

Package Part No.	P/N 37685-55	P/N 36622-55
Pump	36161-55	36161-55
Hose Reel ½" x 33 ft.		8430.401-55
Bung Adaptor	38042-55	38042-55
Digital Meter		37739-55
Extension 1.3" O.D.		10/23-55 37.8"
Flexible Suction Tube	38026-55	
Rigid Suction Tube	38027-55	
Pump Support Bracket	38043-55	36602-55

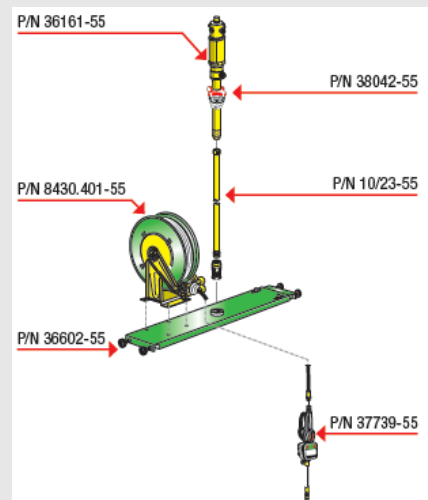
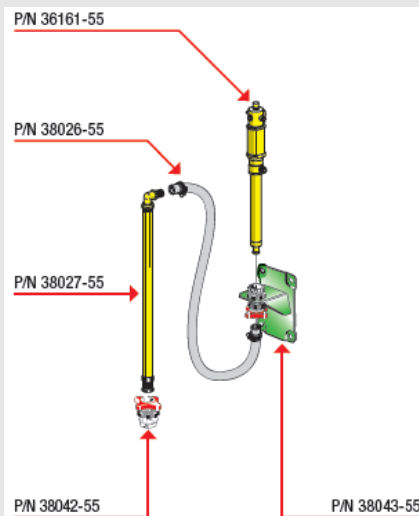

Air Operated Oil Pumps



Series 312 Industrial Pumps for maintenance and production applications

Series 312 industrial air-operated double-acting pumps for distribution suitable for transferring very high viscosity oils and lubricants. The double-action guarantees the delivery of a continuous and constant flow. Particularly effective in systems equipped with multiple distribution points.

5:1 Ratio



7:1 Ratio



Part Number

90C/51-55 5:1 Ratio

91C/71-55 7:1 Ratio

Pump Ratio

5:1

7:1

Pump Output

Up to 45 LPM

Up to 30 LPM

Compatible fluids

lubricants, hydraulic fluid, gear lubes, trans. fluid

lubricants, hydraulic fluid, gear lubes, trans. fluid

Type of Seals

Polyurethane

Polyurethane

Suction Tube – Upper Body

Aluminum

Aluminum

Suction Tube

Carbon Steel

Carbon Steel

Air Inlet Connection

1/2" NPT(f)

1/2" NPT(f)

Fluid Outlet

3/4" NPT(f)

3/4" NPT(f)

Maximum Air Pressure

120 psi

120 psi

Max. Air Cons. @120 psi

60 cfm

30 cfm

Noise Level

80 dB

80 dB

Suction Tube Length

9.5"

37"

Suction Tube O.D.

2.36"

2.09"

PRO/MARK INDUSTRIALS

Div. R.D. Lewis Sales Limited

Manufacturer's Representative

**Applied
Lubrication
Technology Inc.**

Modular Air Operated Oil Pump Packages

With Series 312 Industrial Pumps

System for oil dispensing from tank, with pump applied on wall or on the tank. A modular solution for oil delivery with connection to a centralized system or hose reel or directly to the delivery hose. Ideal for distribution from storage zones. Complete with accessories for connection to the compressed air system and dispensing system.

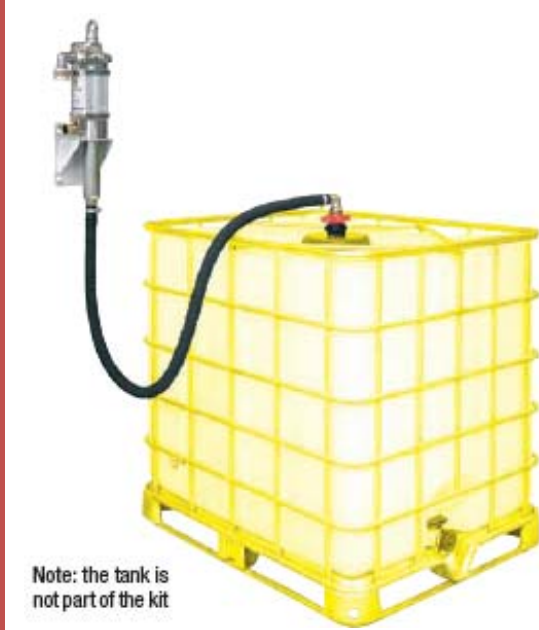

Note: the tank is not part of the kit



Note: the tank is not part of the kit

Package Part No.	P/N 36340-55	P/N 36631-55
Pump	90C/51-55 5:1 ratio	90C/71-55 7:1 ratio
Hose Reel ½" x 33 ft.		8530.401-55
Bung Adaptor	33434-55	37774-55
Extension 1.34" O.D		10/23-55 1.
Foot Valve		10/20-55
Flexible Suction Tube	38026-55	
Rigid Suction Tube	38055-55	
Pump Support Bracket	10/10-55	36602-55

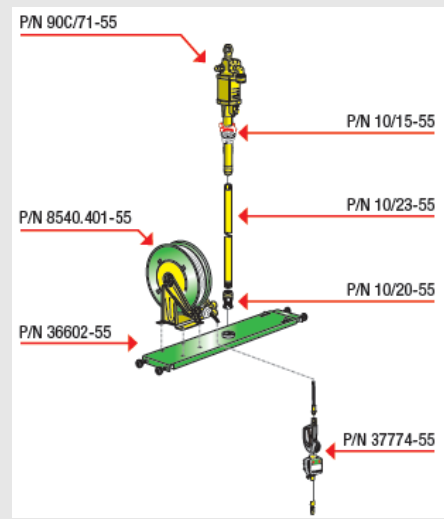
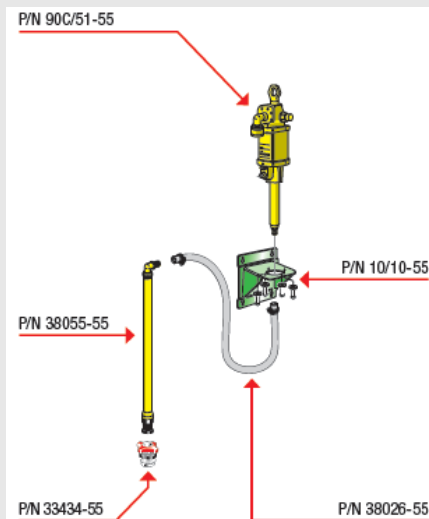

Pump Extensions for various size tanks and containers

Pump Extensions for Series 200 & 238 pumps for various size containers and tanks.

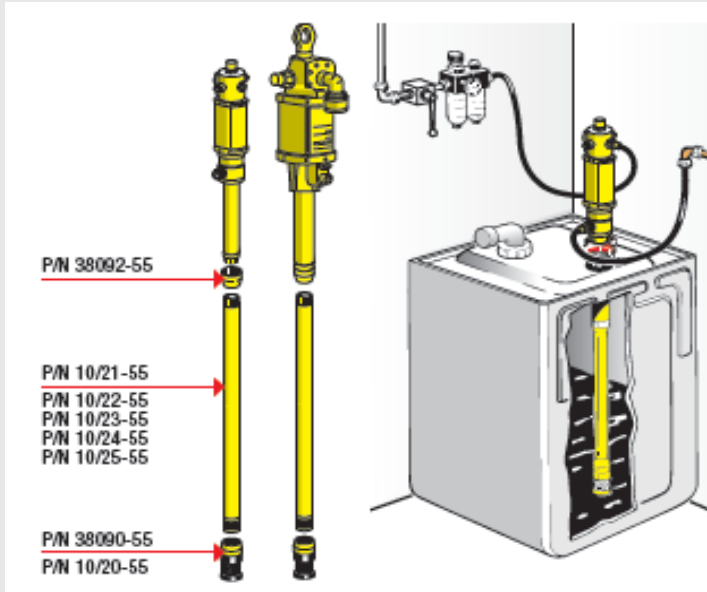

Part No.	Length	For
10/21-55	Length 18"	For 60 liter kegs
10/22-55	Length 26"	For 205 liter drums
10/23-55	Length 38"	For oval tanks – all capacities
10/24-55	Length 50"	For 60" high rectangular tanks
10/25-55	Length 58"	For 66" high rectangular tanks

